

Invictus Yacht TT460

2024

1 474 338 EUR

Beaulieu-sur-mer
excl. VAT

Martial Barey
+33 6 68 70 09 96

EXTERIOR



MAIN CHARACTERISTIC

Length	14,27 m
Beam	4,5 m
Draft	1,20 m
Weight	14 800 kg
Hull color	Wild Bronze
Engine model	Volvo IPS
Power	650 hp
Fuel tank	1300 liters
Water tank	300 liters
Cruising speed	25 knots
Cabins	2
Berths	4

Invictus Yacht TT460

2024
1 474 338 EUR

Beaulieu-sur-mer
excl. VAT

Martial Barey
+33 6 68 70 09 96

DECK PLAN



Main deck

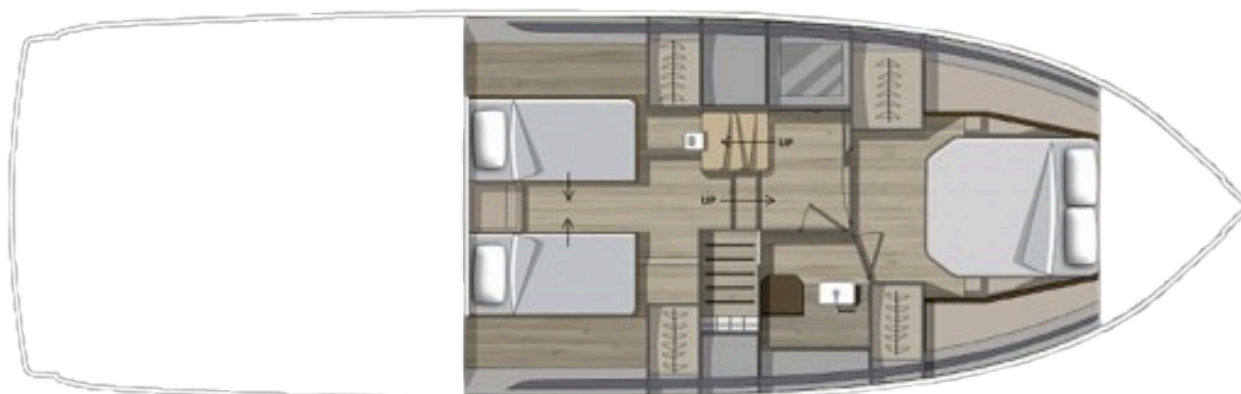

Lower deck

Invictus Yacht TT460

2024

1 474 338 EUR

Beaulieu-sur-mer
excl. VAT

Martial Barey
+33 6 68 70 09 96

CONFIGURATION

STANDARD EQUIPMENTS

- Teak on transom
- Teak cockpit
- Teak side passage
- Tackle rail
- Stainless steel oval section handrail
- 8 retractable cleats
- Invictus logo in front steel
- Fender storage
- Courtesy and ambient lights
- Carbon T-top with LED light
- Crystal windscreen with wipers
- Driver's seat electric air deflector
- Full bar unit with sink and 230V induction hob + 230V socket
- 2 teak cockpit tables
- 2 cushions transforming tables into sunbeds
- Tende da finestra forward cabin
- Forward cabin with dinette (lower deck V01)
- Aft cabin with pull-out double bed (lower deck V01)
- Bathroom with separate shower
- Cabin fridge (200 L)
- 12V electrical system
- AC system and shore power 230VAC 50 Hz
- Batteries
- HI-FI fusion system with 6 HP
- TV ready
- Fresh water system VTR 360 L
- Grey water system
- Black water system VTR 230 L
- Dockside black water suction cap
- Cockpit shower with mixer tap
- Cold water shower box
- Bowler 30 L
- 'Display Glass cockpit 16" Chartplotter GPS Volvo with transducer
- Interceptor kit 450mm
- Bow thruster
- Compass
- Steering wheel
- Retractable swim ladder
- Electric windlass with anchor and stainless steel chain
- Garage for 2.5 MTR tender
- Complete awning kit

Invictus Yacht TT460

2024

1 474 338 EUR

Beaulieu-sur-mer
excl. VAT

Martial Barey
+33 6 68 70 09 96

CONFIGURATION

COLORS

- Wild Bronze hull
- Cocoa Upholstery

ADDITIONAL EQUIPMENT

- Tilt out gangway and Hydraulic platform (500Kg max load)
- 4 Underwater lights
- Deep / Search Lights
- Aft cockpit canvas shadows with carbon poles
- 2 painted domies
- Rollaway and foldable ladders
- Kit 130L mobile bar refrigerator
- Cockpit icemaker
- Coffee machine
- Stainless steel hull protection plate for lashing ropes (6 pieces)
- Bow cabin TV
- Second cockpit glass screen 16
- Anchor locker camera
- Volvo autopilot
- Software for auto trim intercept system
- Radar Gmr 18Hd 4Kw
- Gyroscope MC2x10 (only with fisher panda generator)
- Satellite antenna
- Garmin VHF 315i
- Mase 8.5 Kw generator
- Reversible hot/cold air conditioning (27,000 BTU)
- Mooring protection kit
- Kit no. 8 Invictus leather opening fenders
- Tender winch
- Transport, IPS assembly, technical inspection, warranty validation, antifouling,
- Truck unloading and craning

COMFORT

- Extra bed (stern bed)
- Extra bed (bow bed)
- Cabin blackout curtain kit

INTERIOR AND EXTERIOR DESIGN

- Aft gates
- Storage space inside the stand-up
- Diving door for bow space plus additional bathroom door (only with Lower deck V02)

AUDIO SYSTEM

- Invictus Fusion Lounge Hi-Fi system with 16 speakers

Invictus Yacht TT460

2024
1 474 338 EUR

Beaulieu-sur-mer
excl. VAT

Martial Barey
+33 6 68 70 09 96

PHOTOS



Invictus Yacht TT460

2024
1 474 338 EUR

Beaulieu-sur-mer
excl. VAT

Martial Barey
+33 6 68 70 09 96

PHOTOS

